

Wave Brake Mop Bucket with Wringer

Color-Coded

- Meet HAACP compliance standards
- Prevent cross-contamination by using one color in each area of the restaurant



How-to Video:



Molded-In Baffles

- Also known as "Wave Brakes"
- Reduce splashing and spilling by 40%, keeping liquid off the floor
- Reduce the risk of slips and falls from wet floors

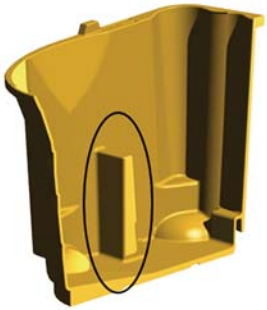

Traditional Bucket



With Wave Brakes

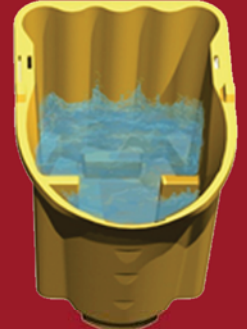

Non-Rusting Plastic Casters

- Allow for easy mobility
- Reduces the need to pick up the bucket when moving throughout the restaurant



Century Products LLC
404 Edwardia Drive
Greensboro, NC 27409
(336) 292-8090



facebook.com/centuryproductsllc



@CenturyLLC



www.centuryproductsllc.com

CENTURY

Wave Brake Mop Bucket with Wringer

How-to Video:



High Efficiency Wringer

- Requires 25% less effort to wring mops
- Reduces strain on employees, cutting their risk of injury



Dirty Water Insert

- Keeps dirty water away from cleaning solution
- Dirt does not end up back on the floor, producing cleaner, less slippery floors
- Divides the weight of the liquid, using less lifting power and reducing strain on employees emptying the chambers
- Separate chambers improve image so customers do not see dirty water



Dirty Water Insert in Bucket

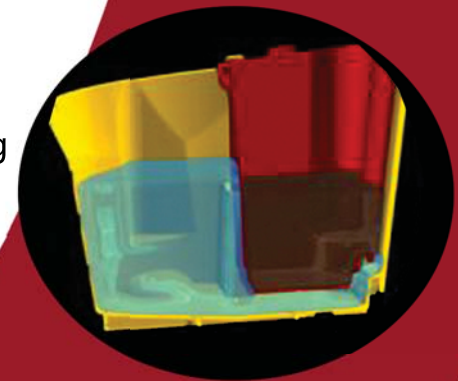

Easy Lift Handle

- Allows employees to easily pick up mop bucket or dirty water insert
- Reduces back strain and associated injuries



Century Products LLC
404 Edwardia Drive
Greensboro, NC 27409
(336) 292-8090



facebook.com/centuryproductsllc



@CenturyLLC

www.centuryproductsllc.com

CENTURY

Wave Brake Mop Bucket with Wringer

Product Use

1. Lock dirty water insert into place by turning latch
2. Fill mop bucket with approved cleaning solution
3. Place mop in solution then into wringer to remove excess water
4. Press down firmly on mop bucket wringer
5. When finished mopping, wring out mop into dirty water insert
6. Once dirty water insert is full, unlatch and remove insert to discard soiled solution
7. Repeat steps until finished cleaning floor



Lock insert into place



Dip mop in bucket



Insert mop into wringer



Press firmly on wringer



How-to Video:



Century Products LLC
404 Edwardia Drive
Greensboro, NC 27409
(336) 292-8090



facebook.com/centuryproductsllc



@CenturyLLC

www.centuryproductsllc.com

CENTURY